

## USING THE FRAME LEVELING

1. Make sure that the BOOM is below 15 ° (information on the screen)
2. Make sure that the turret is turned to less than 10 ° left or right.
3. Press orange button to the right or left to level the machine

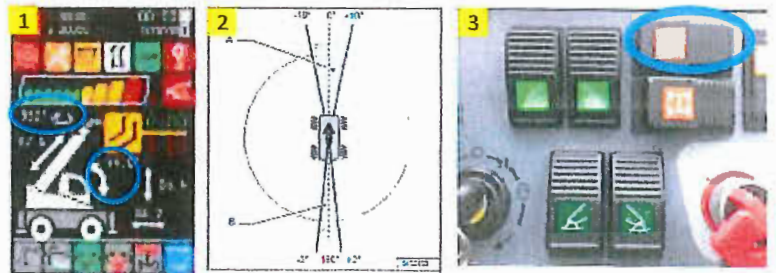

## USING THE STABILIZERS – MANUAL MODE

1. To the right of the steering wheel, select the stabilizers by pressing downward the corresponding button (illuminated when activated). It is possible to select each stabilizer independently.
2. To the left of the steering wheel, press and hold downward the stabilizer activation button.
3. Then:
  - Move the joystick forward to telescope the selected stabilizers.
  - Move the joystick backwards to retract the stabilizer
  - Turn the right thumb switch forward to lower the stabilizer.
  - Turn the right thumb switch backwards to raise the stabilizer.

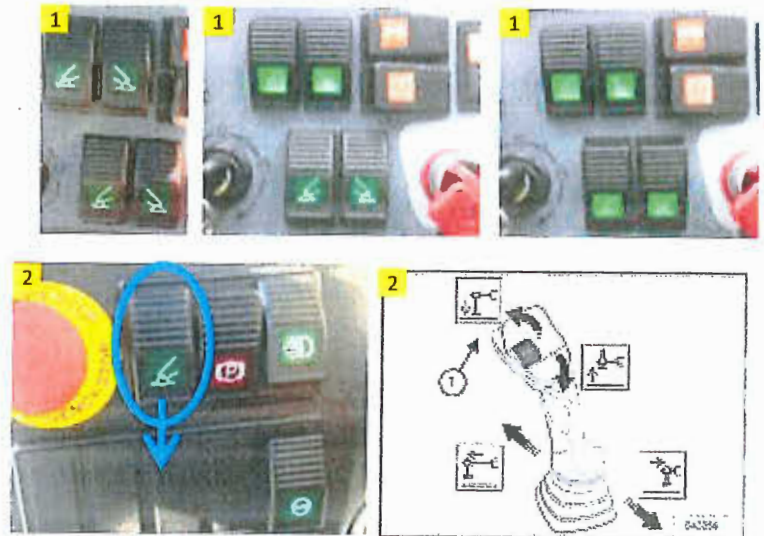

## USING THE STABILIZERS – AUTO MODE

1. Once the four stabilizers are telescoped as desired, press and hold upward the stabilizer activation button while holding the right joystick in your hand.
2. The operation stops as soon as the machine is levelled.



## USING JOYSTICKS

1. The joysticks incorporate a hand detection system. Detection is confirmed by the green light on the joystick dial.
2. When used with gloves, hands detection is done by pressing the button on the back of the joysticks

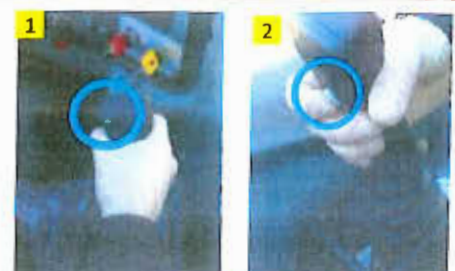

## TURRET LOCKING

1. Put the turret in the front position, i.e. 0° with respect to the machine axis (green indicator of turret alignment switched on).
2. Simultaneously press the "lock/unlock turret" button (located on the right pillar of the cabin) and turn the right thumb switch to lock or unlock the turret.
3. A turret lock icon appears to confirm the locking



## USING THE RADIO CONTROL

1. Put imperatively the machine on stabilizers
2. Set FNR lever to Neutral
3. While the engine is on or the key is in the "contact" position, press the remote control button located on the right pillar of the cabin. (The engine turns off when switching to remote control mode)
4. Switch on the remote control (rotating button "on/off"). The screen lights up.
5. Press the green "Transmitter-Receiver Link" button. An alarm will sound and the remote control will activate.
6. Switch on the engine start button by holding it for 2 seconds
7. Press one of the two activation buttons for the boom / turret commands

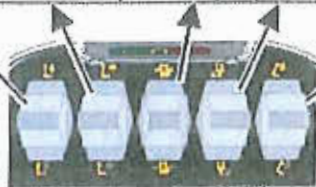

Boom/Turret controls

Boom speed (Slow/Fast)



Secondary auxiliary control

Engine ignition

Engine Idle Control

Refer to the operator's manual for all operating instructions

## MACHINE DELIVERY

Cabin storage compartment (opening with starter key): *Tool kit with emergency pump lever, grease pump, motor interface connection cable, push pull plugs, loosening key wheels, flat key set and 1 screwdriver.*



In the cab, the remote control (optional), the rotating beacon and the operator's manual in the box behind the seat.

## STARTING MACHINE FROM THE CAB

1. Sit on the seat (operator sensing detector)
2. Check if emergency stop is in relaxed position.
3. Check if "Remote control" switch is turned off. (Button up and locked)
4. Set FNR lever to Neutral.
5. Turn the start key to 1, wait until the red status bar is displayed fully.
6. Start the machine.



## MOVING MACHINE

With the engine started

1. Disengage Park Brake (press down button)
2. Make sure that the turret is turned to less than 10° left or right.
3. Operate the reversing switch (FNR lever) upwards (Forward) or downwards (Reverse)
4. Press the accelerator pedal gradually to regulate the travel speed

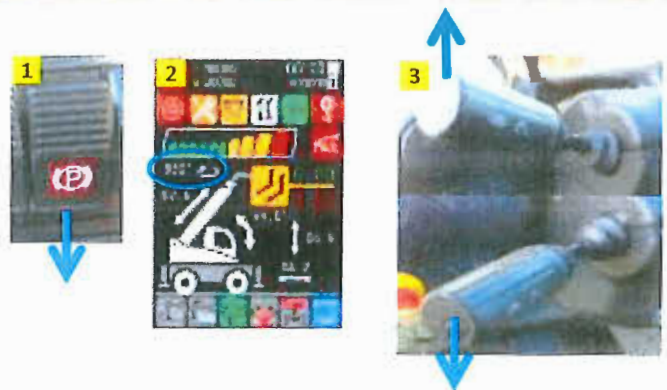

## MECHANICALLY CHANGING SPEED

With the engine started

1. Set FNR lever to Neutral
2. Press simultaneously the brake pedal and the inching pedal
3. Press the mechanical speed shift button (to the left of the steering wheel)
4. Check the dashboard for change from Rabbit to Turtle or Turtle to Rabbit
5. Gently accelerate after shifting if the warning light is not steady (synchronization of the gears)

